

Microsoft Edge – Setting Default Home Page

These directions will guide you through resetting your default page in the Edge browser on a Windows 10 device.

1. **Access** the **Edge browser** using a Windows 10 device.



2. **Click** on the  icon in the far right-hand corner of the browser page.

3. **Select Settings** in the drop down menu

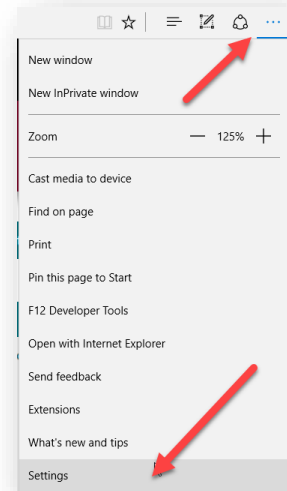

4. **Click** on the drop down menu for **“Open Microsoft Edge with”** and select **“A specific page or pages”**.

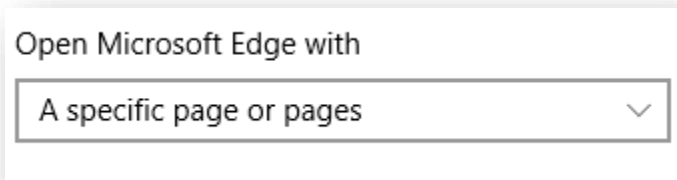

5. **Enter** the **URL** that you want to be the start page of your Edge browser and **click** on the **“floppy drive” icon** to save.

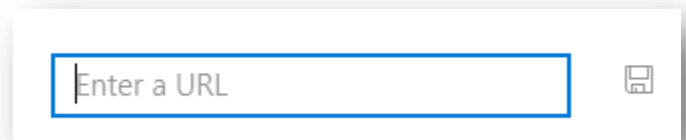

6. Click the “X” in the far right-hand corner of the Edge browser to close the browser. Access Edge and the URL you added will be your home page.