

Extended Desktop Mode in Windows 10

These directions will explain how to set up extended desktop mode in Windows 10.

1. By default, your laptop will be in a duplicate display. Change to extended desktop by **holding the Fn (Function) key + F8** (or **Windows key  + P**) to bring up the project menu. Then select **Extend**. Having an extended desktop provides a second screen to house additional windows and applications.

Note: Notice the left half circle on the laptop image and right half circle on the monitor image.

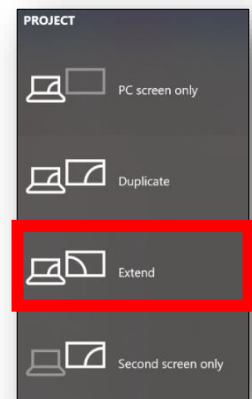

2. The desktop background is now extended to your second monitor, the Interactive Flat Panel. To use this extended screen, **click and drag your open windows** from left to right on your laptop, and they will transfer to your extended desktop on the flat panel screen.

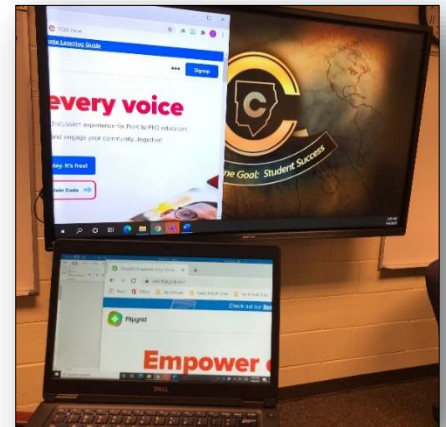

3. You can return to a duplicate desktop display by **holding the Fn (Function) key + F8** (or **Windows key  + P**) to bring up the project menu. Select **Duplicate**, and this will mirror your laptop screen to the second screen, the Interactive Flat Panel.

